

Mounting Bracket Installation

- Installation for 10ZiG RBT Thin Clients.

10ZiG's line of RBT Series Thin Clients are small, energy efficient units that can easily be mounted on the back of a monitor. The following instructions detail the steps for mounting the unit either vertically or horizontally onto the back of most VESA standard monitors using the VESA mounting bracket available from 10ZiG.

Parts Needed:



Monitor



Thin Client



VESA Mounting Bracket (1)



RBT Mounting Bracket (1)



Mounting Screws (5)

Note



The bracket needs to be mounted on the side of the thin client without the manufacturer's label and the bottom arrow on the bracket should be facing down towards the back or bottom of the unit depending on how the bracket is being mounted.

Unit Mounting Configuration

1. Remove the circular piece from the center of the unit to expose the screw hole (ensuring to remove the side without manufacturer's label).
2. Install the smaller bracket, using one of the mounting screws (provided). Attach the mounting bracket to the unit by threading the screw through the pre-existing mounting holes.
3. Turn the screw to hold unit bracket firmly in place (do not overtighten). *(See Figure 1.)*

Figure 1.

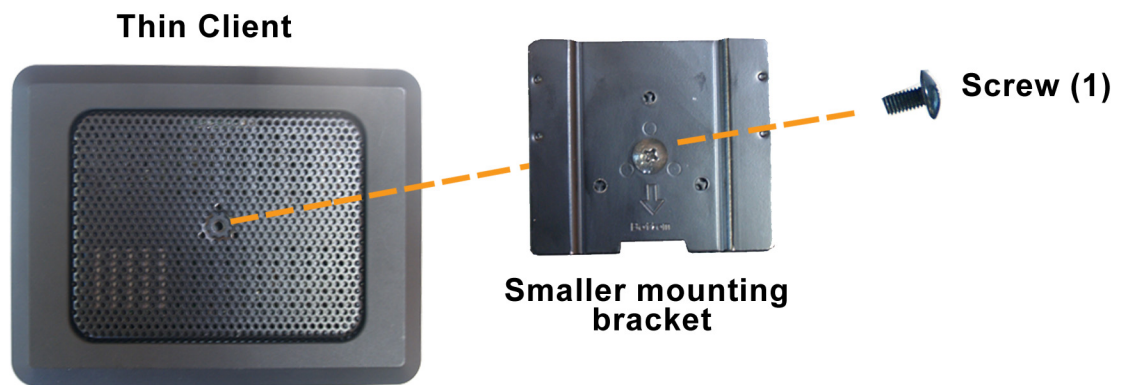

Monitor Mounting Configuration

Note If the unit will be mounted vertically, ensure the bracket rails are pointing vertically with the bottom arrow pointing to the bottom of the unit. If the unit is being mounted horizontally, ensure the bracket rails are positioned horizontally with the bottom arrow facing the back of the unit.

1. Align the four slits on the VESA mounting bracket with the four corresponding holes on the monitor.
2. Insert the four remaining screws (provided) into each corner and tighten the screws to hold the bracket firmly in place (do not overtighten). (See *Figure 2.*)

Figure 2

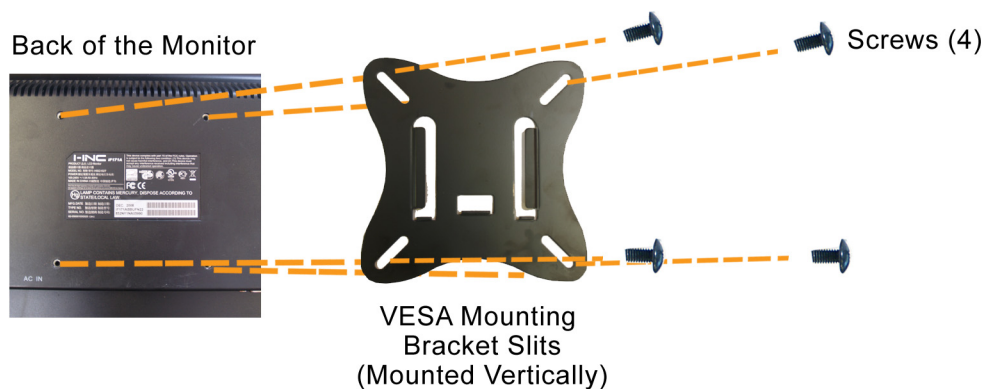

Mounting Configuration

1. Align the unit bracket rails with the monitor bracket rails and slide the unit onto the bracket until the unit snaps into place. (See *Figure 3.*)

Figure 3.

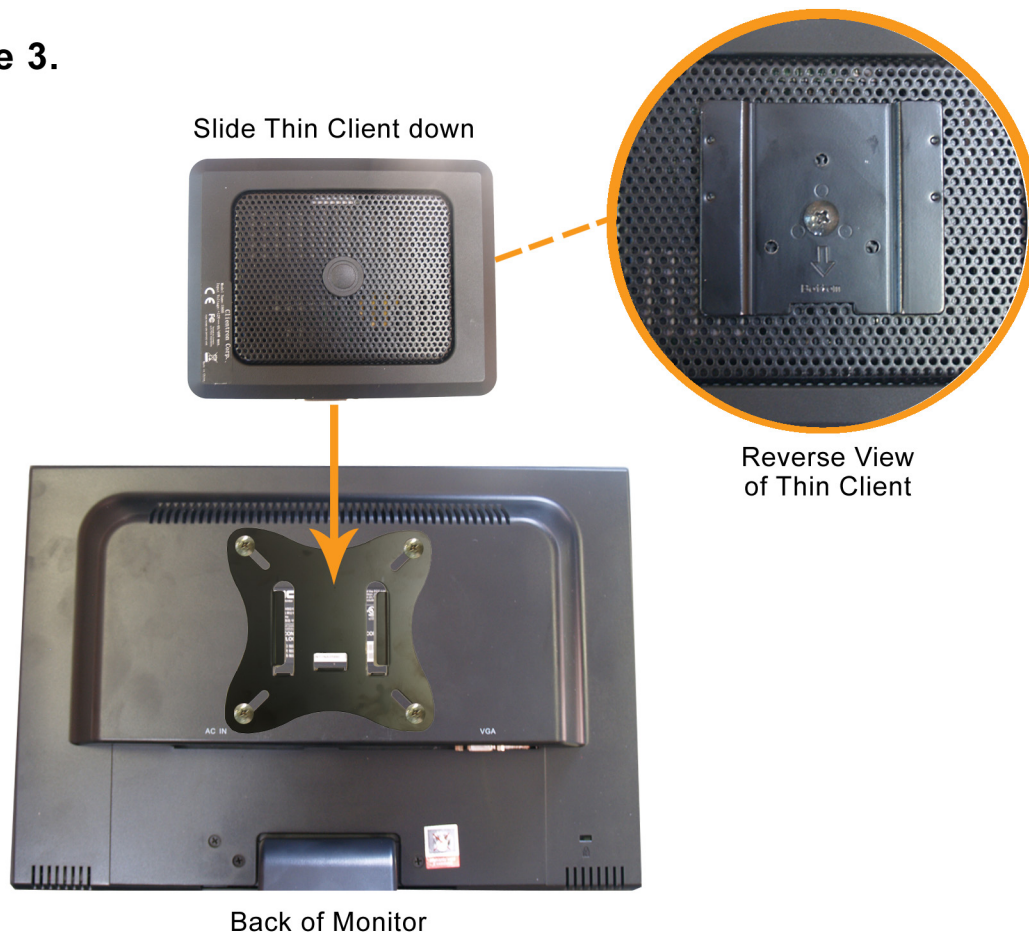

2. Attach the cables to their respective connectors on the back panel of the thin client.



Do not connect power until all other connections are made.